



(12) **United States Patent**  
**Beane**

(10) **Patent No.:** **US 7,755,224 B2**  
(45) **Date of Patent:** **Jul. 13, 2010**

(54) **SYSTEM FOR PRODUCING ELECTRICITY THROUGH THE ACTION OF WAVES ON FLOATING PLATFORMS**

(76) Inventor: **Glenn Beane**, 71 Stevens Rd., Hanover, NH (US) 03755

(\* ) Notice: Subject to any disclaimer, the term of this patent is extended or adjusted under 35 U.S.C. 154(b) by 239 days.

(21) Appl. No.: **12/079,591**

(22) Filed: **Mar. 27, 2008**

(65) **Prior Publication Data**

US 2008/0224472 A1 Sep. 18, 2008

**Related U.S. Application Data**

(63) Continuation-in-part of application No. 11/593,895, filed on Nov. 7, 2006, now abandoned.

(60) Provisional application No. 60/734,203, filed on Nov. 7, 2005.

(51) **Int. Cl.**  
**H02K 35/02** (2006.01)

(52) **U.S. Cl.** ..... **310/12.12**; 290/42

(58) **Field of Classification Search** ..... 310/12.12; 290/42, 53; 60/497, 498, 502, 505, 506  
See application file for complete search history.

(56) **References Cited**

**U.S. PATENT DOCUMENTS**

3,717,103 A	2/1973	Guderjahn
3,837,287 A	9/1974	Lichtenberg
4,123,667 A	10/1978	Decker
4,207,739 A	6/1980	Scarpi
4,266,143 A	5/1981	Ng

4,364,715 A	12/1982	Bolding
4,392,061 A	7/1983	Dubois et al.
4,719,158 A	1/1988	Salomon
5,347,186 A *	9/1994	Konotchick ..... 310/17
5,710,464 A *	1/1998	Kao et al. .... 290/53
6,831,373 B1 *	12/2004	Beaston ..... 290/43
7,288,860 B2 *	10/2007	Cheung et al. .... 310/12.12
2003/0116971 A1	6/2003	Likitcheva
2009/0160191 A1 *	6/2009	Beane ..... 290/53

**FOREIGN PATENT DOCUMENTS**

FR	2504986	11/1982
FR	2523654	9/1983
SU	1363393	12/1987

\* cited by examiner

*Primary Examiner*—Dang D Le

(74) *Attorney, Agent, or Firm*—Devine, Millimet & Branch, P.A.; Raymond I. Bruttomesso, Jr.; Paul C. Remus

(57) **ABSTRACT**

A system and method for producing electricity through the action of waves on floating platforms. The hydraulic force of the water in the waves causes the platform to create a series of reverse incline planes. The system adjusts or tunes the frequency of various components in relation to the natural frequency of the waves. The system has a mass carried on a track that moves relative to the track to create kinetic energy. One feature is to have the track and the mass tuned to the hull. Another feature is to tune the track and mass and the hull relative to the waves to increase power generated. In addition, the system has a microprocessor in one embodiment, that takes input related to waves, the mass, and the floating platforms and actively tunes parameters to increase the power generated. As a mass moves down the reverse incline planes, it gains mechanical energy, which is then converted into electrical energy.

**19 Claims, 16 Drawing Sheets**

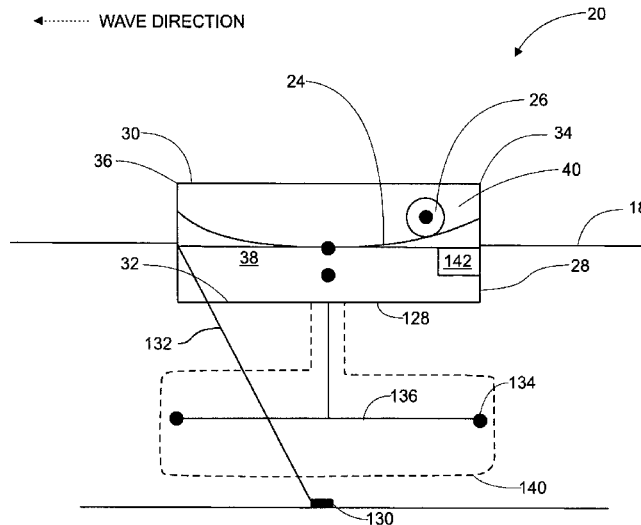

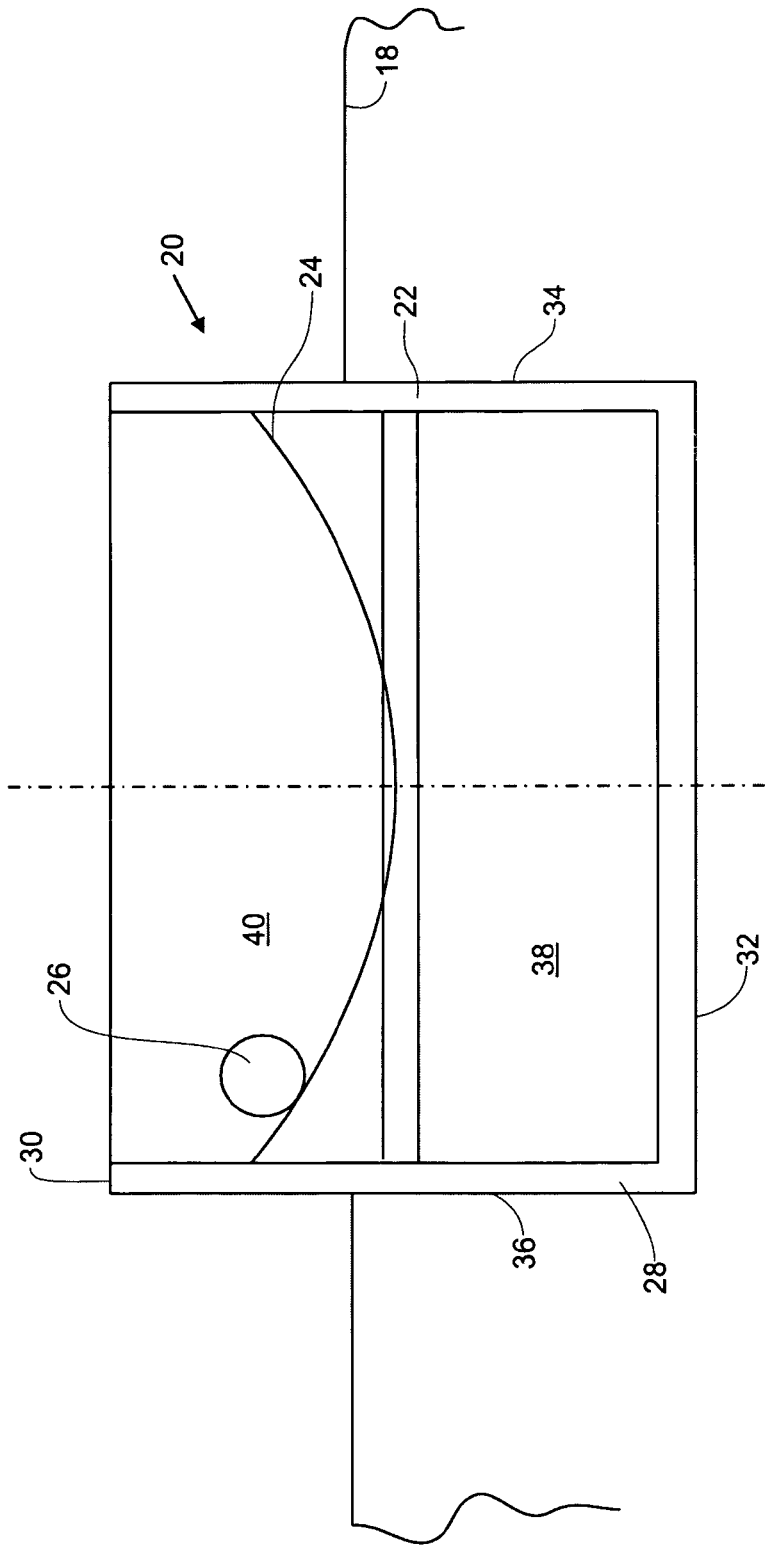

FIG. 1

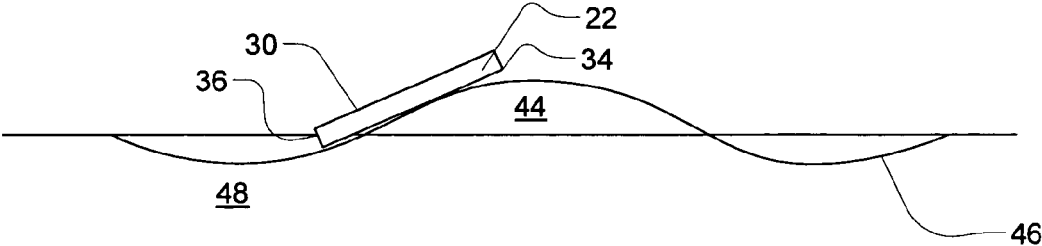

FIG. 2A

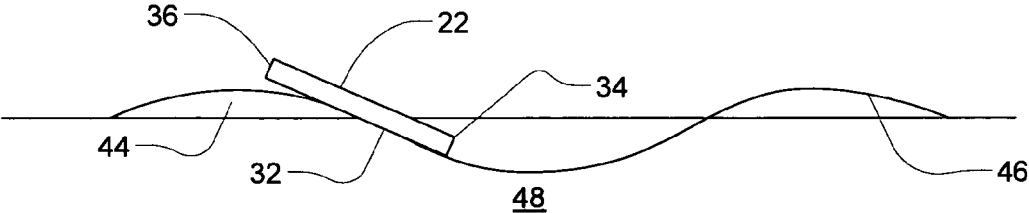

FIG. 2B

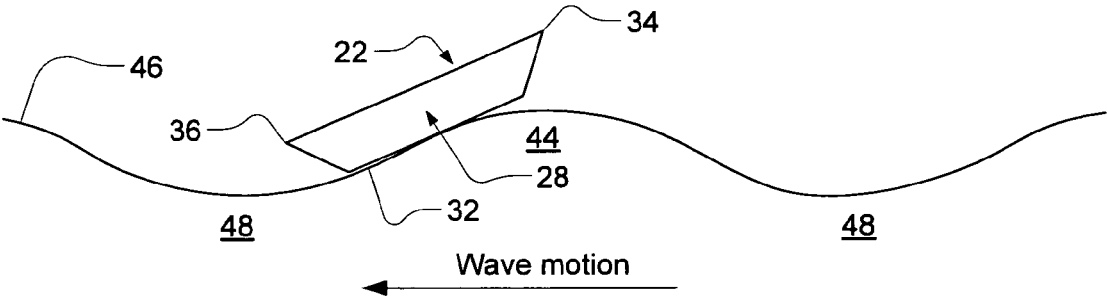

FIG. 3

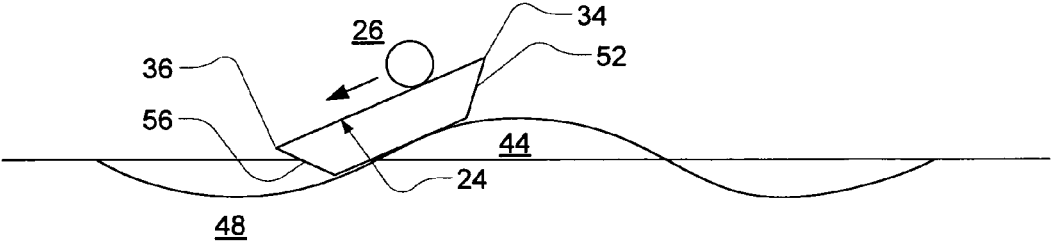

FIG. 4A

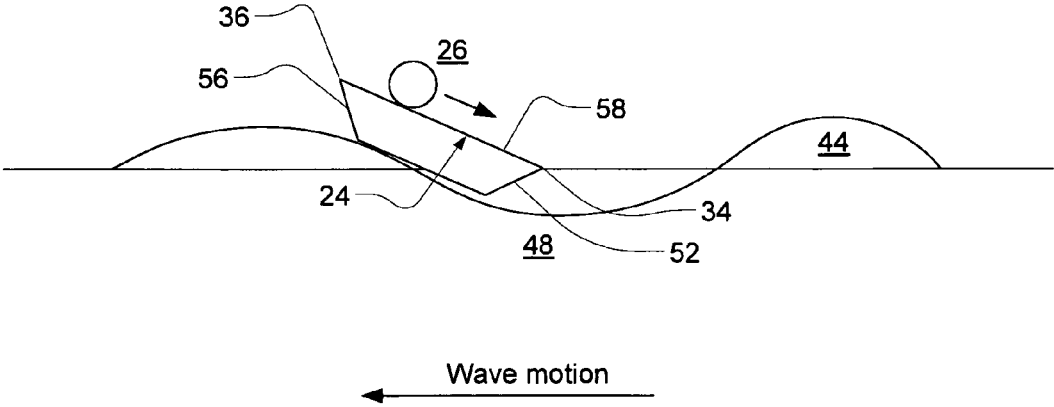

FIG. 4B

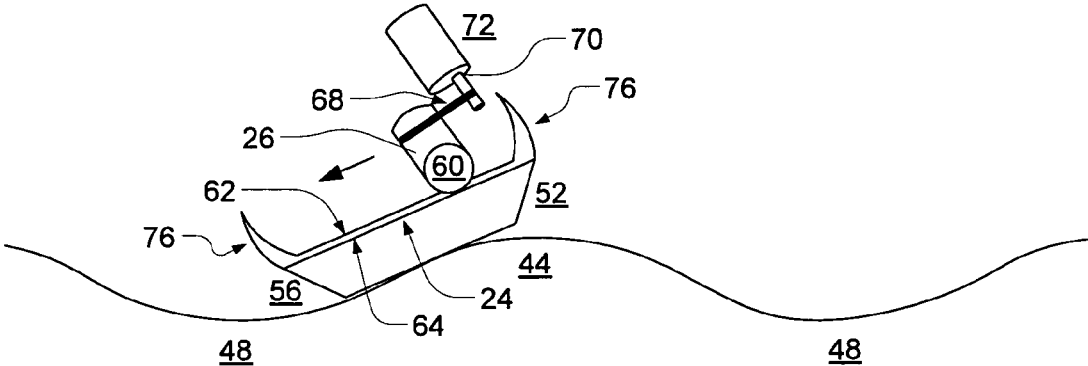

FIG. 5

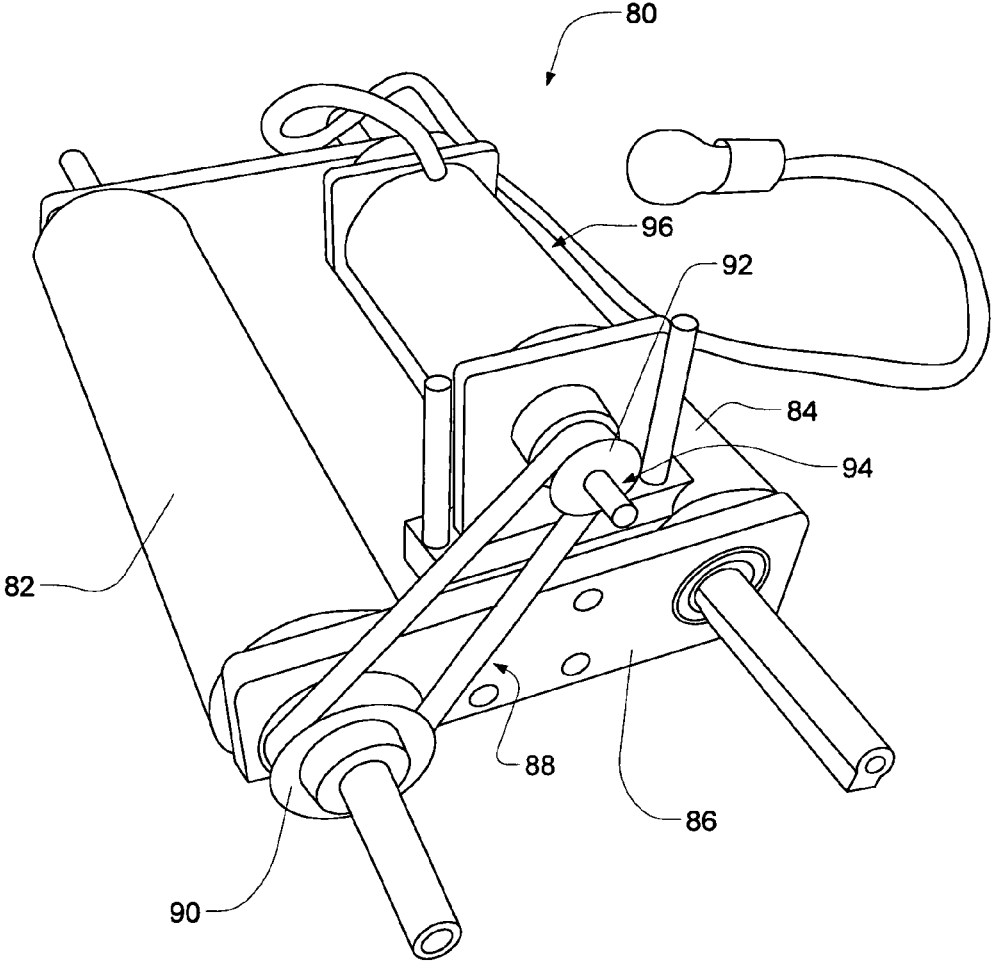

FIG. 6A

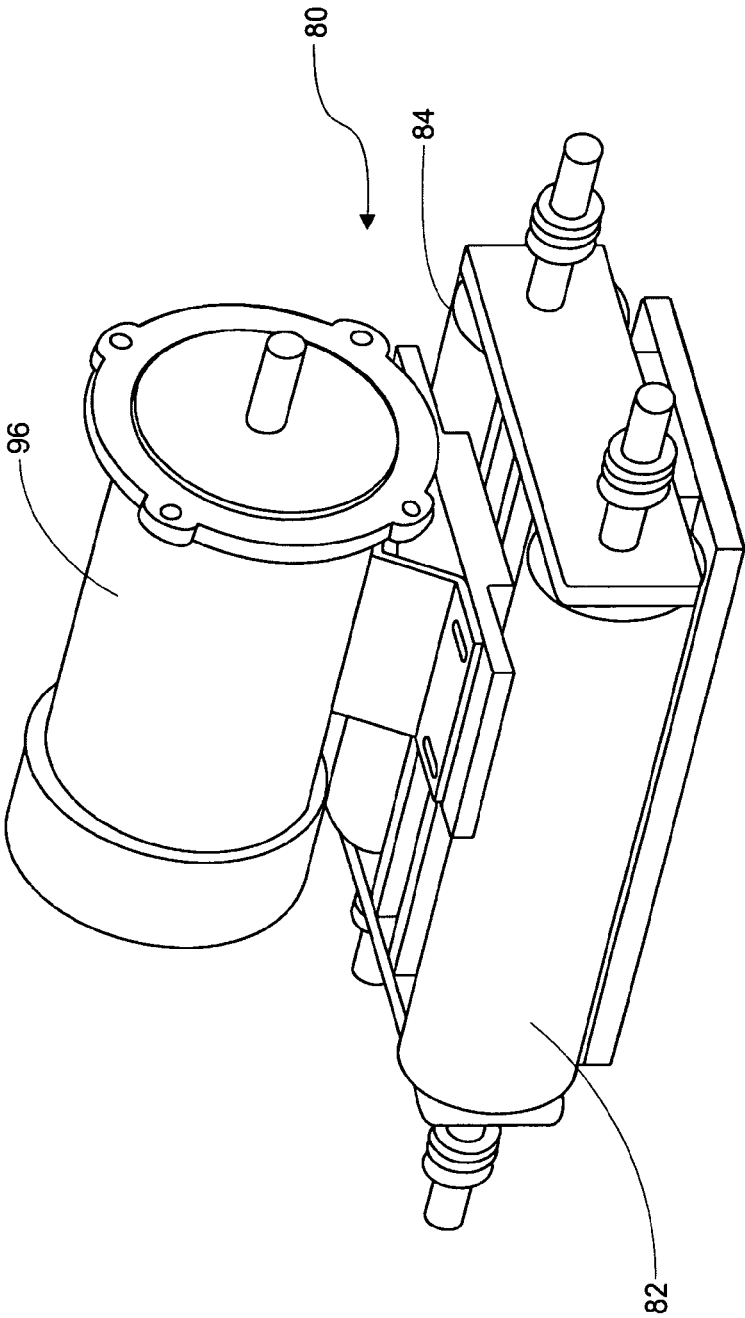

FIG. 6B



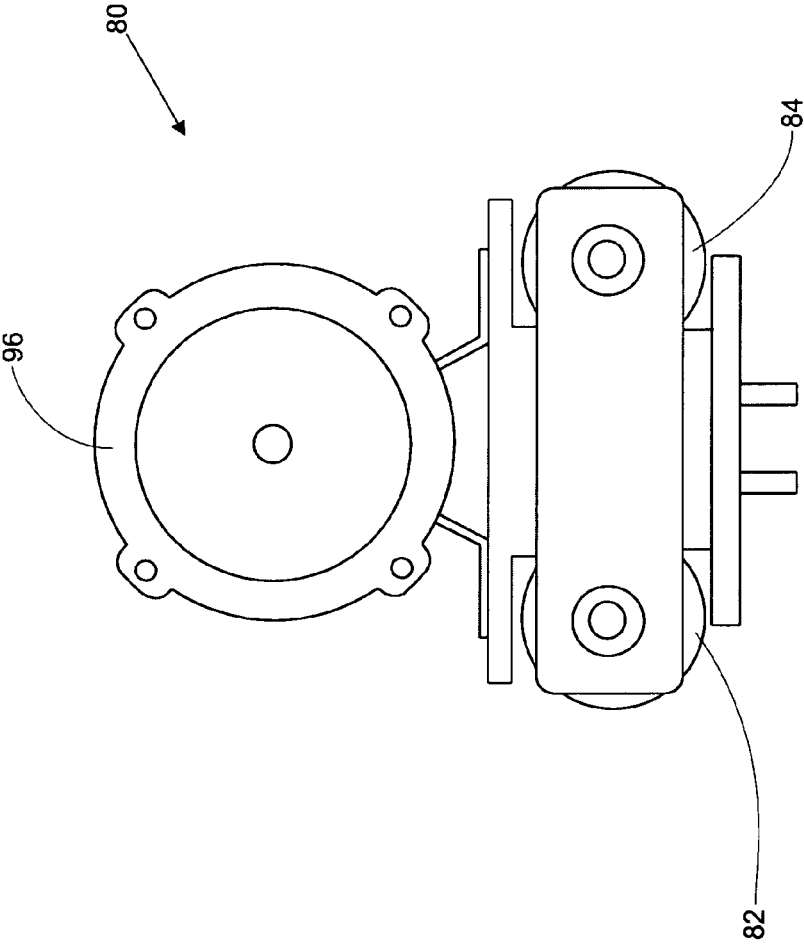

FIG.6C

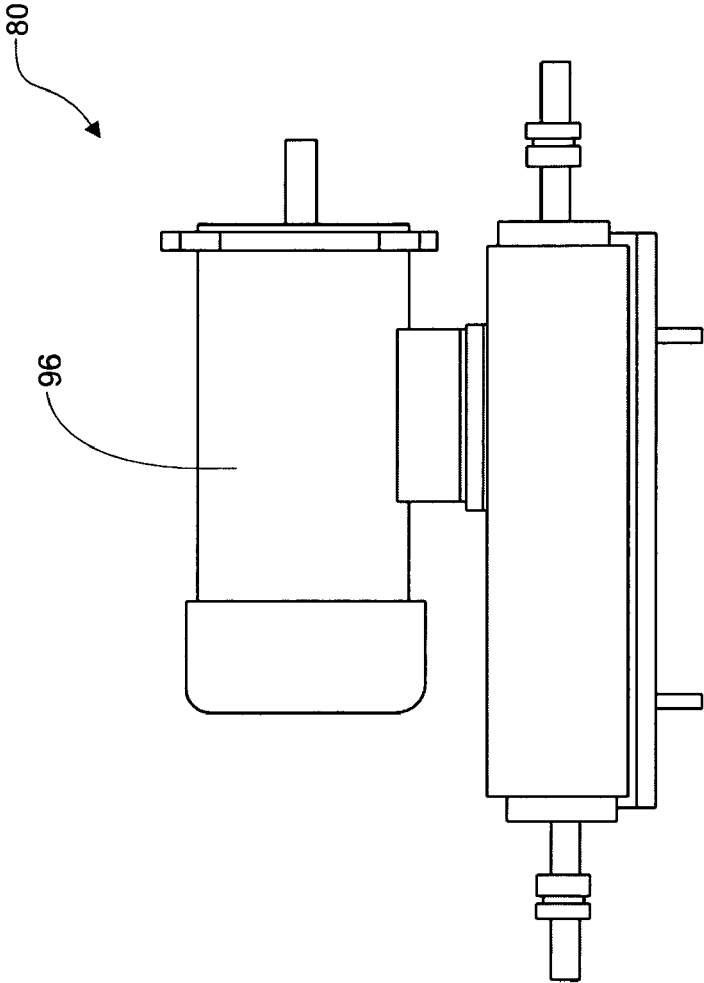

FIG.6D

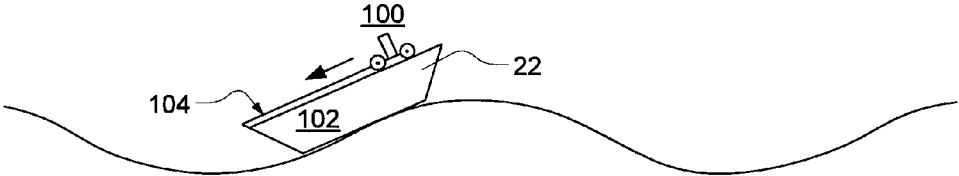

FIG. 7

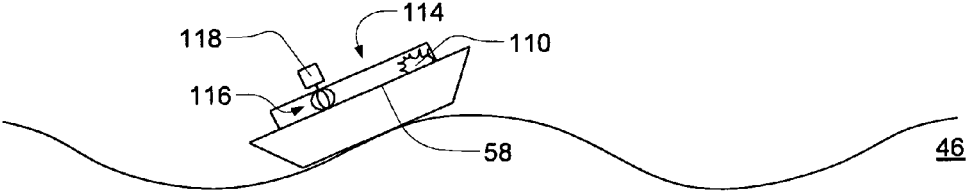

FIG. 8

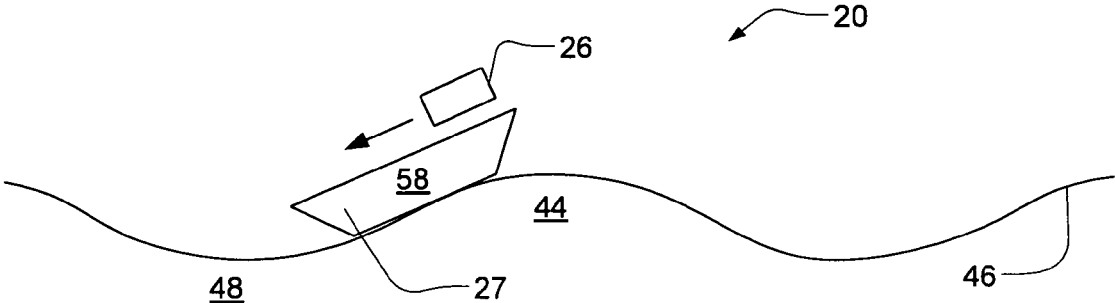

FIG. 9

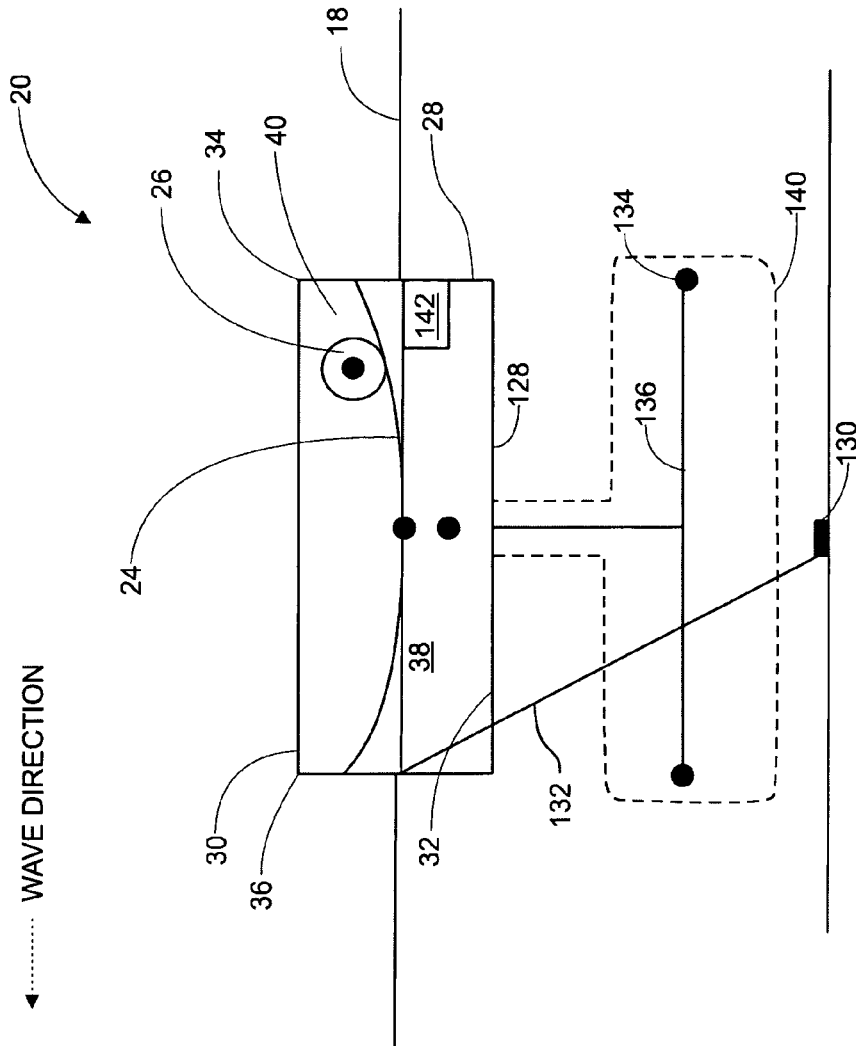

FIG.10

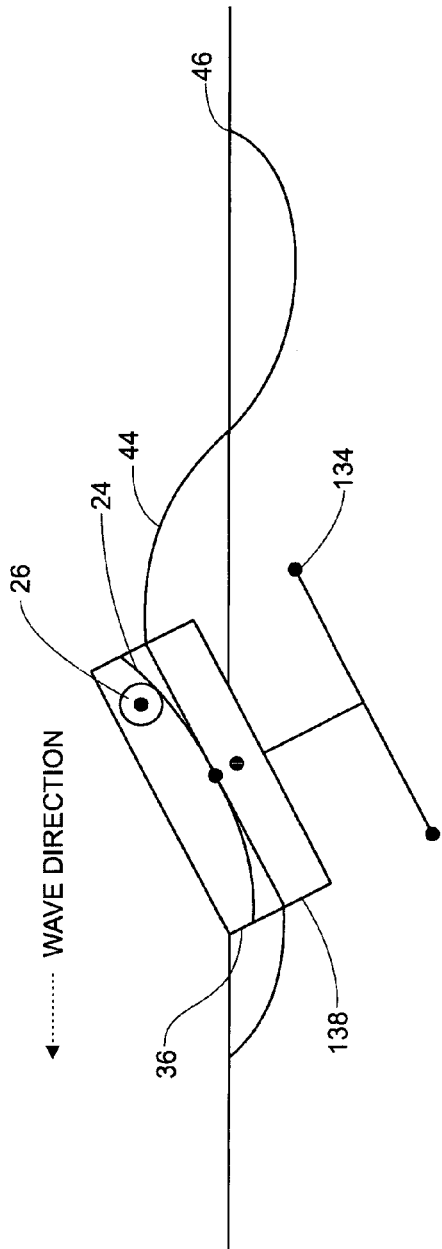

FIG. 11A

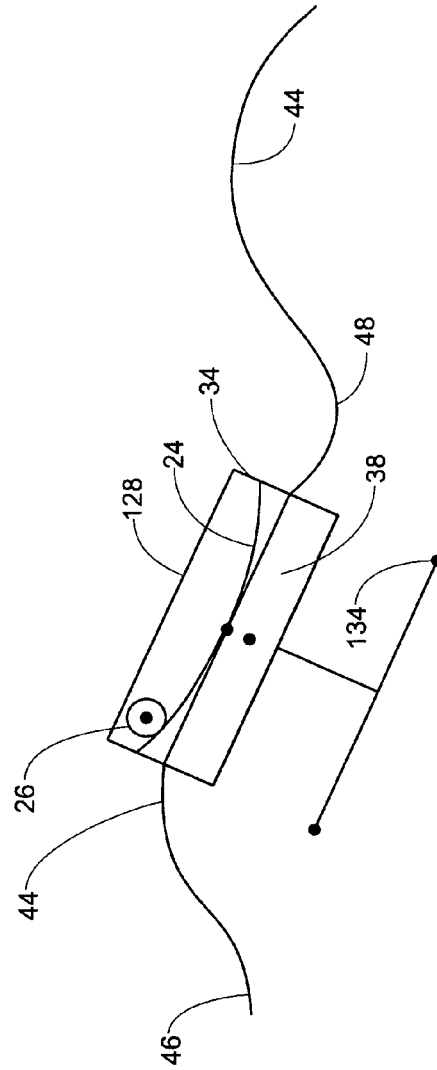

FIG. 11B

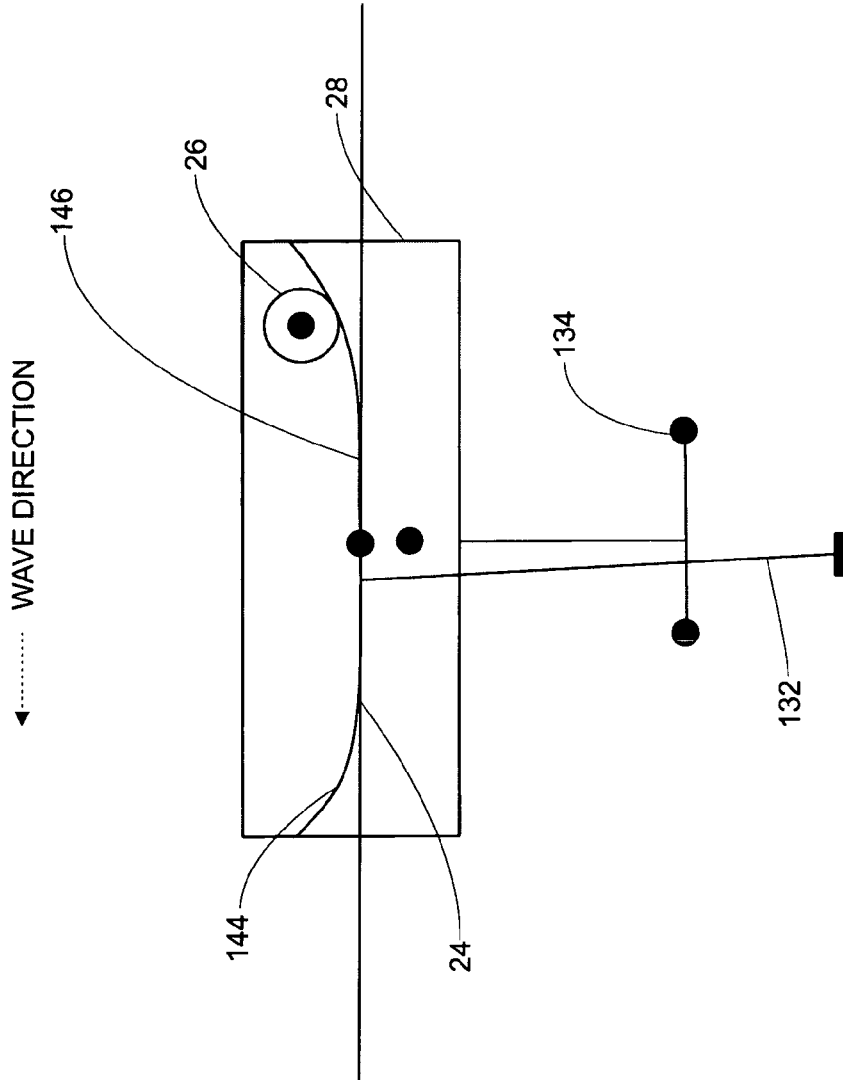

FIG.12

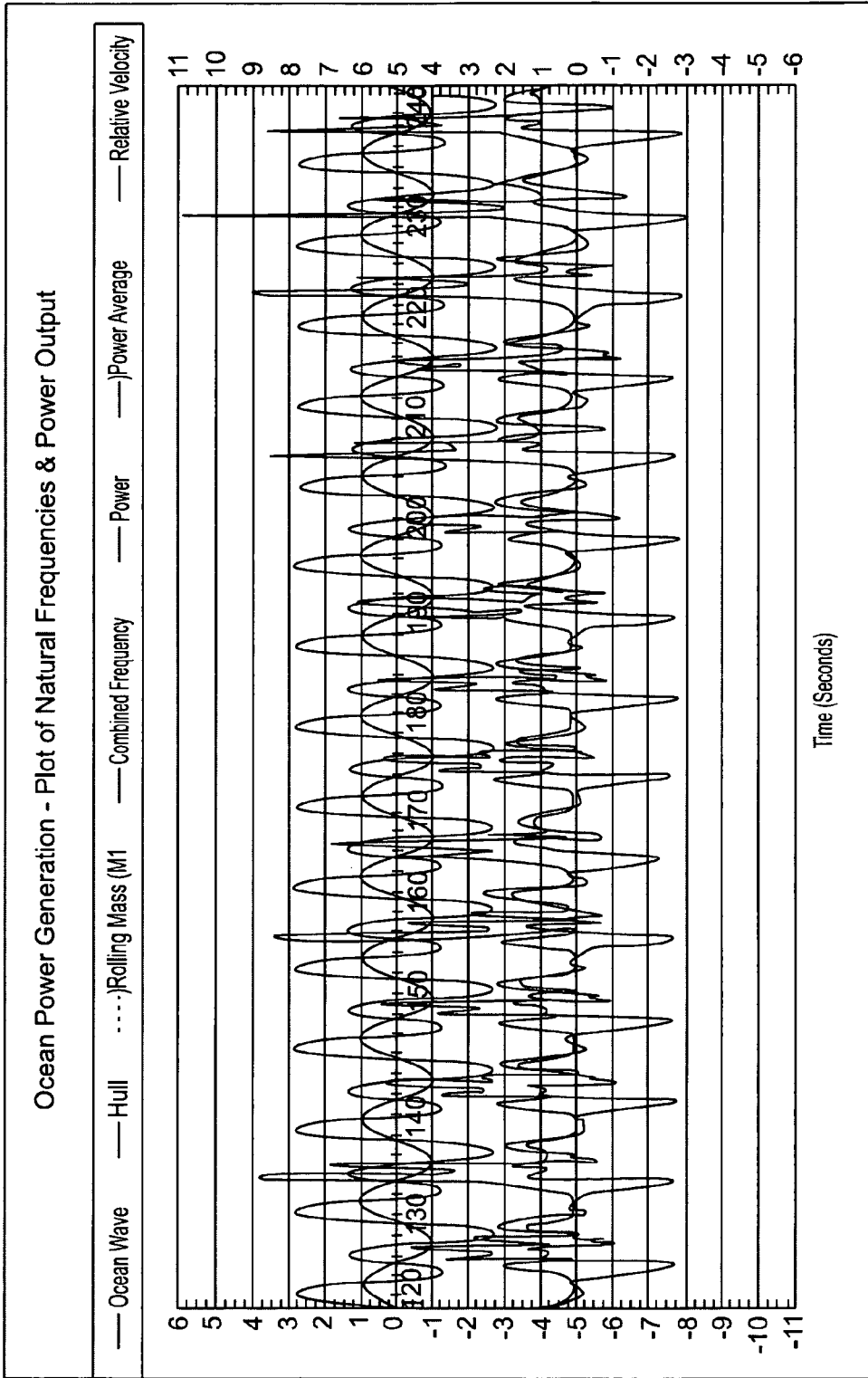

FIG.13



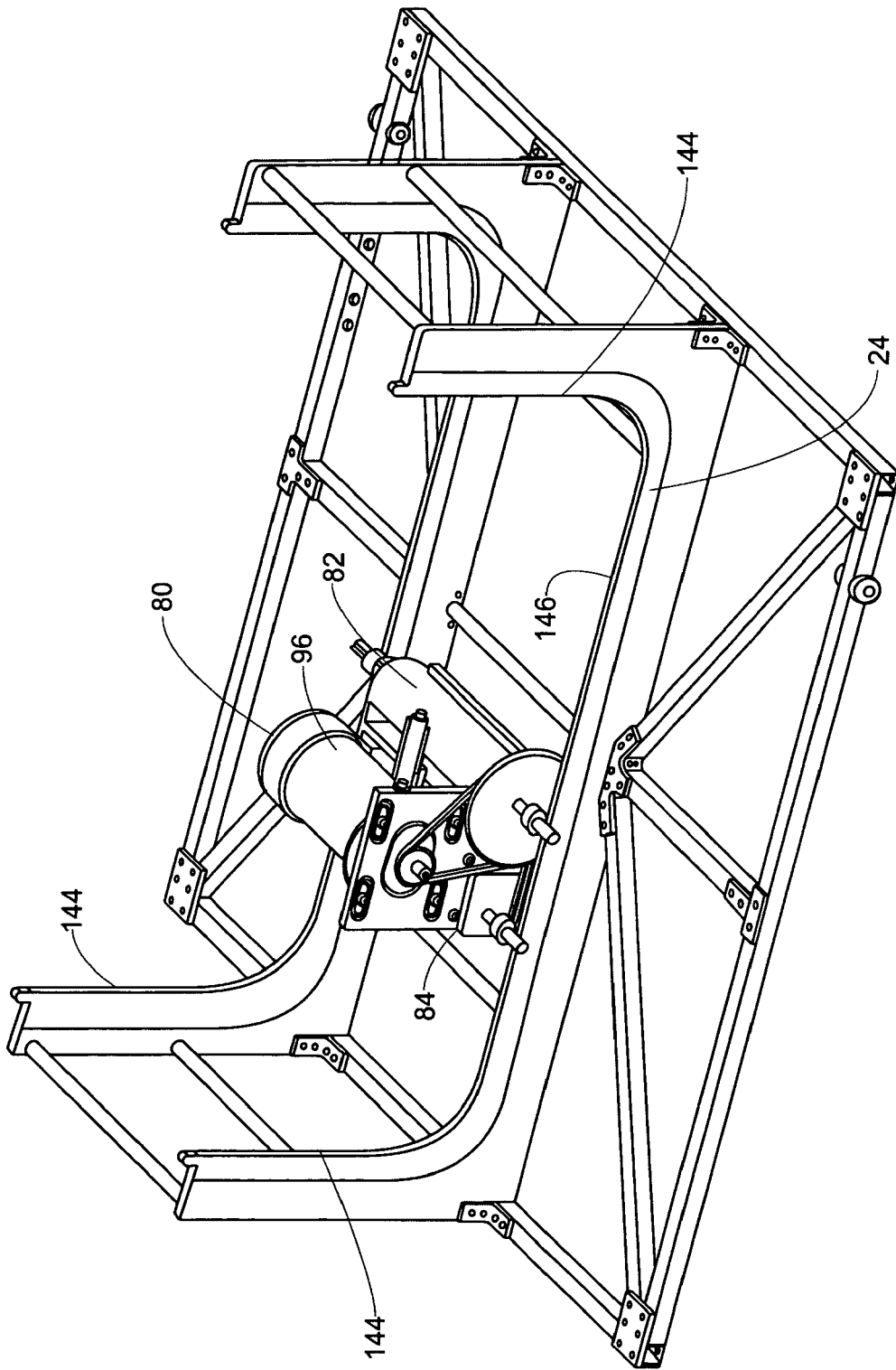

FIG.14

1

## SYSTEM FOR PRODUCING ELECTRICITY THROUGH THE ACTION OF WAVES ON FLOATING PLATFORMS

### CROSS-REFERENCE TO RELATED APPLICATIONS

This application is a continuation-in-part of U.S. patent application Ser. No. 11/593,895 filed on Nov. 7, 2006 now abandoned which claims the benefit of U.S. Provisional Patent Application 60/734,203, filed Nov. 7, 2005, which are incorporated herein by reference.

### FIELD OF THE INVENTION

The present invention is a system and method for producing electricity. More particularly, it is a system and method for producing electricity through the action of waves on floating platforms.

### BACKGROUND OF THE INVENTION

There are numerous approaches to producing electricity from the hydraulic force of the localized movement of water in large bodies of water. Water moving as a result of tides, winds, or gravity, for example, has been used as a hydraulic force to move some turbine, door, or other part of a larger apparatus anchored to land. This approach is expensive, not very efficient, and prone to breaking down both because of the difficulty in anchoring the apparatus to land and because the ocean is corrosive and small sand particles in the ocean cause excessive wear.

The power density of wind and water, two abundant natural resources, is very low. It is not until wind is blowing in excess of 100 MPH that it will blow a standing person over, and if a person is floating in even large ocean waves the force of the waves flows by you because water is a low-density liquid. One can feel the energy of the wave, but the force is minimal as compared to standing in the road and being hit by a bus traveling at the same speed as the wind or water. Force equals the density of an object multiplied by the speed that it is traveling, so very low-density substances like wind and water do not make very good energy resources because the scale of energy projects for wind and water have to be extremely large and expensive and can also have extensive environmental impact on our planet, such as large hydro projects.

The solution to creating bountiful, renewable, non-carbon producing, cheap energy for our planet is to figure out a way to generate high power density energy like that of a coal fired or nuclear power plant using low-density wind and/or water, the most plentiful resources on our planet.

The present invention does not rely on stationary machinery, but produces electricity through the hydraulic force of the water in waves on floating platforms.

Unfortunately, prior attempts to produce electrical power from waves have failed to appreciate the various degrees of freedom involved and therefore have been inefficient. Furthermore, some systems have been unstable with components diverging even in relatively calm sea states.

### SUMMARY OF THE INVENTION

The present invention is a system and method for producing electricity through the action of waves on floating platforms. A mass is placed on a floating platform having a leading edge and a trailing edge. Waves then alternately raise the leading edge of the platform over the trailing edge and the

2

trailing edge of the platform over the leading edge, thereby creating a series of reverse incline planes. As the mass moves down the reverse incline planes, the rolling mass gains mechanical energy. Then the mechanical energy of the moving mass is converted into electrical energy.

In contrast, the system and method of the instant invention tailors the system by tuning various components to maximize the power generated. The system adjusts or tunes the frequency of various components in relation to the natural frequency of the waves. The system has a mass carried on a track that moves relative to the track to create kinetic energy. One feature is to have the track and the mass tuned to the hull. Another feature is to tune the track and mass and the hull relative to the waves to increase power generated. In addition, the system has a microprocessor in one embodiment that takes input related to waves, the mass, and the floating platforms and actively adjusts (tunes) parameters to increase the power generated.

A system for generating electricity from the hydraulic forces of waves includes a floating platform with a leading edge and a trailing edge floating on a body of water on which water in waves exerts hydraulic forces on floating objects. A track is mounted on the floating platform. A mass is carried on the track for moving relative to the track creating kinetic energy as the result of varying the orientation of the track by the hydraulic forces acting on the platform. A mechanism is to convert the kinetic energy of the mass moving along the track into electrical energy. A mechanism tunes the mass relative to the floating platform to increase energy generated.

In an embodiment, the mechanism for tuning the mass relative to the floating platform includes adjusting the track therein varying the path of the mass. The mechanism for tuning includes a pair of curved track portions and a flat portion, the pair of curved track portions adjusted to vary the length of the flat portion of the track.

A method for generating electricity from the hydraulic forces of waves on a body of water has a floating platform having a track for carrying a mass. The floating platform has a leading edge and a trailing edge on a body of water. The method utilizes waves on the body of water to raise the leading edge of the platform over the trailing edge, thereby the track forming an incline plane. This results in the mass moving down the track thereby gaining kinetic energy. The kinetic energy of the mass moving down the track is used to turn a generator to produce electricity. The system tunes the mass and the track relative to the waves to increase the energy generated.

In one method the floating platform including tunable masses in the keel is tuned relative to the mass and the track and the waves to increase the energy generated. In a method, the floating platform is tuned by moving the location of a mooring line on the hull.

### BRIEF DESCRIPTION OF THE DRAWINGS

These and other features and advantages of the present invention will be better understood by reading the following detailed description of embodiments, taken together with the drawings wherein:

FIG. 1 is a schematic diagram of a floating platform;

FIGS. 2A and 2B are schematic diagrams of the reverse incline planes produced by a wave;

FIG. 3 is a schematic diagram of a ship incorporating one of the incline planes produced by a wave as shown in FIG. 2;

FIGS. 4A and 4B are schematic diagrams of a moving mass on the incline plane of the ship shown in FIG. 3;

FIG. 5 is a schematic diagram of a rolling cylinder on the incline plane of the ship shown in FIG. 3;

FIG. 6A is a diagram of a mass comprised of two substantially cylindrical masses;

FIGS. 6B-6D are various views of the unit having the masses;

FIG. 7 is a schematic diagram of a rolling wheeled vehicle on the incline plane of the ship shown in FIG. 3;

FIG. 8 is a schematic diagram of a moving liquid on the incline plane of the ship shown in FIG. 3;

FIG. 9 is a schematic diagram of an electromagnetically suspended mass on the incline plane of the ship shown in FIG. 3;

FIG. 10 is a schematic diagram of an alternative embodiment of the floating platform;

FIGS. 11A and 11B is a schematic diagram of the floating platform of FIG. 10 on a wave;

FIG. 12 is a schematic diagram of the floating platform of FIG. 10 with various elements tuned;

FIG. 13 is a graph of the natural frequencies of various elements of the system and the power output for one experimental run of the system; and

FIG. 14 is an isometric view of the track with the unit having the rolling masses.

#### DETAILED DESCRIPTION OF EMBODIMENTS

Two-thirds of the earth's surface is covered with water. Three-fourths of the earth's population lives within close proximity to an ocean or other large body of water. All of these people need electricity.

The wind blowing on the surface of an ocean or other large body of water (hereinafter, collectively, the "Ocean") efficiently converts wind energy into wave energy. The present invention is a system for converting the energy of waves on the Ocean into low-cost, efficient, reliable, clean electricity.

Referring to FIG. 1, a system 20 having a floating platform 22 on a body of water 18 without waves, a track 24, and a mass 26, a rolling energy generating mass, is shown. The floating platform 22 has a hull 28 including a top surface 30, a bottom surface 32, a leading edge 34, and a trailing edge 36. The hull has a buoyancy compartment 38 and an energy generating portion 40. The track 24 and the mass 26 are located in the energy generating portion 40 as explained in greater detail below.

Wave energy can be converted into useful mechanical energy through the hydraulic force of the water in a wave causing a floating platform 22 to act as a series of incline planes. Referring to FIGS. 2A and 2B, the floating platform 22 is shown in two positions relative to a crest 44 of a wave 46. For simplification, the floating platform 22 is shown with the entire platform 22 above the water 18. It is realized that the platform 22 would be partially under the water because of buoyancy and displacement of water as explained below with respect to FIG. 10.

Still referring to FIG. 2A, the floating platform 22 is shown with the top surface 30, the bottom surface 32, the leading edge 34, and the trailing edge 36. As the crest 44 of a wave 46 reaches the leading edge 34 of the platform 22, the hydraulic force of the water raises the leading edge 34 relative to the trailing edge 36 creating an incline plane. As the crest 44 of the wave 46 passes under the platform 22, the hydraulic force of the water no longer raises the leading edge 34, which now falls into a trough 48 of the wave 46, relative to the trailing edge 36.

Referring to FIG. 2B, the leading edge 34 has fallen into the trough 48 relative to the trailing edge 36 of the floating plat-

form 22. The hydraulic force of the water now raises the trailing edge 36 relative to the leading edge 34 creating another incline plane. For purposes of this description, an incline plane first with its leading edge higher than its trailing edge and then with its leading edge lower than its trailing edge, will be described as the reverse of each other. Thus, the action of the moving waves causes a series of incline planes, any given incline plane being the reverse of both the incline plane that precedes it and the incline plane that follows it.

It should be noted that the floating platform 22 with a bottom 32 that is flat both in the direction of the motion of the waves and transverse to the motion of the waves, as opposed to rounded or v-shaped, is a more efficient incline plane. It should also be noted that the length of the incline plane formed by a floating platform from the leading edge 34 (bow) to the trailing edge 36 (stern) can be increased. One method is by raising the energy generating portion 40, which is shown as the top surface 30 of the platform 22 relative to the bottom surface 32 of the platform 22 with an angled hull, as would customarily be the case of the deck of a ship 22 relative to its hull 28, as shown in FIG. 3.

The energy of a series of moving waves is converted into mechanical energy through the movement of a mass down a series of reverse incline planes formed by the hydraulic force of the water in the waves on a ship's hull. As is discussed below, the mass may be solid or liquid and may take any one of a number of forms known to those skilled in the art. Referring to FIG. 4A, when the crest 44 of a wave raises the bow 52 of a ship 54 relative to the stem 56 (the trailing edge 36), it creates an incline plane 58 of the track 24. The force of gravity then causes the mass 26 to move down the incline plane 58 from the bow 52 to the stem 56. As the crest 44 of the wave 46 passes under the ship 54, the bow 52 of the ship 54 sinks relative to the stem 56 into the trough 48 of the wave 46 creating a reverse incline plane as shown in FIG. 4B. The force of gravity now causes the mass 26 to move down the reverse incline plane 58 of the track 24 from the stem 56 to the bow 52. It should be noted that a ship embodying these principles may be positioned transverse to the direction of the wave motion causing a mass to move down reversing incline planes from one side of the ship to the other.

The greater the mass 26 moving down the incline planes, the greater the mechanical energy created. It should be noted that this source of energy is renewable because the waves 46 continuously create reverse incline planes, causing the mass 26 to repeat continuously its motion from the bow to the stem and back to the bow.

The energy of the mass moving down the series of reverse incline planes is converted by known means into electrical energy using a generator. One ft. lb. of force per second equals 1.356 watts of electricity; so, the amount of force required to move 1.0 lb a distance of 1.0 ft. in 1.0 second is equal to 1.356 watts of electricity. As an example, 100,000 ft. lb. of force per second created by a mass moving down an incline plane equals 135,600 watts of electricity. Preferred embodiments of means for converting the mechanical energy of the moving waves to electrical energy are described below, but other means known to those skilled in the art are available.

Referring to FIG. 5, a cylinder 60 of a suitable, preferably dense solid material or a hollow cylinder filled with a suitable, preferably dense liquid is the mass 26 shown. The cylinder 60 rolls down the track 24 formed of rails 62 on the deck 64 of the ship 54. The rails 62 of the track 24 form the incline plane 58 from the bow 52 to the stem 56 of the ship 54. The rails 62 of the track 24 minimize friction by reducing the surface area rather than the cylinder 60 rolling on the larger surface of the deck which forms the incline plane 58, therein causing the

5

cylinder 60 to roll faster, thereby creating more mechanical energy. Sprockets and chains or similar means (not shown) can be used to prevent the cylinder 60 from sliding down the track 24 rather than rolling.

Still referring to FIG. 5, a belt drive 68 is fastened around the circumference of the cylinder 60 and attached to a shaft 70 of an electric generator 72. As the cylinder 60 rolls down the track 24, it turns the shaft 70 of the generator 72, producing electricity. The revolutions per minute of the cylinder 60 can be controlled by varying the diameter of the cylinder 60 and the shaft 70 of the generator 72, or by using gears and other means known to those skilled in the art.

As also shown on FIG. 5, when the cylinder 60 reaches the end of the incline plane 54, if it is still rolling, any residual mechanical energy can be temporarily stored by having the cylinder 40 roll up a radius 76 of the track 24 until it stops. When the incline plane 54 reverses, the mass 26 initially travels down the radius 76, releasing stored mechanical energy prior to rolling down the reverse incline plane. Alternatively, if the mass 26 is still rolling at the end of the incline plane 54, electricity can be generated through the use of a braking device (not shown), known to those skilled in the art, that co-generates electricity as it stops the mass 26.

Referring to FIG. 6A, the mass 26 is formed of a unit 80 having two substantially cylindrical masses 82 and 84 connected by a frame 86. A belt drive 88 is connected to a sprocket 90 on an extension of one of the cylindrical masses 82 and a sprocket 92 on a shaft 94 of an electrical generator 96. As the cylindrical masses 82 and 84 roll down the reverse track 24, such as in FIG. 5, the mass 82 turns the shaft 94 of the generator 96 producing electricity.

A prototype of the present invention, as shown in FIG. 6A comprises custom stainless steel construction of the cylindrical masses 82 and 84 and frame 86. The belt drive 88 and timing gear (not shown) were purchased from Stock Drive Products of New Hyde Park, N.Y., and the generator is a low RPM permanent magnet DC generator purchased from Windstream Power, LLC of North Ferrisburgh, Vt.

Referring to FIGS. 6B-6D, the unit 80 with the cylindrical masses 82 and 84 are shown.

Electricity generated by the present invention can be stored, for example in batteries, on the ship on which it is produced or can be transmitted concurrently with its production through underwater cables to the power grid.

Another preferred embodiment is shown in FIG. 7. In this embodiment, a wheeled vehicle 100 rolls down an incline plane 102 on a track 104. The mechanical energy of the moving vehicle is converted to electricity by driving the shaft of an electric generator with a belt (not shown) attached to the axles or wheels of the wheeled vehicle 100. Alternatively, although it is not as efficient, the linear motion of the wheeled vehicle 100 can be converted into rotary motion to drive an electric generator via a screw drive or other means known to those skilled in the art. This approach also allows the generator to be fixed to the platform 22, as opposed to the embodiments shown in FIGS. 5 and 6 in which the generator is fixed to the moving mass 26. It should be clear that, in practice, one or more moving masses can drive one generator or one moving mass can drive one or more generators.

In still another preferred embodiment, as shown in FIG. 8, a volume of a suitable liquid 110, such as water, can be used to flow down an incline plane 58. The flowing water 110 is diverted through a duct, pipe, or other channel 114 to a turbine 116. The flowing water drives the turbine 116 which, in turn, drives a generator 118. Various means known to those skilled in the art, such as separate channels, can be used to insure that the turbine is turned in the same direction by the flowing water

6

regardless of the direction of the flow of the water as it flows down a series of reverse incline planes.

In still another embodiment, as shown in FIG. 9, a mass 26 can be suspended above an incline plane 58 by electromagnetic force. This will eliminate friction between the mass 26 and the incline plane 58. As the mass 26 moves down the incline plane, various means described above or known to those skilled in the art can be used to convert the mechanical energy of the motion into electricity.

Referring to FIG. 10, an alternative floating platform 128 of the system 20 is shown in a body of water 18 without waves. The floating platform 128 has a track 24 and a mass 26, a rolling energy generating mass, which follows the track 24. The floating platform 128 has a hull 28, including the top surface 30, the bottom surface 32, the leading edge 34, and the trailing edge 36. The hull 28 has a buoyancy compartment 38 and an energy generating portion 40. In addition, the system 20 has a mooring anchor 130. It is attached to the trailing edge 36 of the floating platform 128 by a mooring line 132. In addition, the system 20 has a pair of tuning masses 134 along a tunable bar 136 located below the floating platform 128. The tunable bar 136 hangs below the bottom surface 32 of the floatable platform 128 by a line 138. The tunable masses 134 can be varied along the length of the tunable bar 136 to vary the moment of inertia of the tunable masses 134 in relation to the floatable platform 128. In addition, the tunable masses 134 can be moved up and down relative to the bottom surface 32 of the hull.

The tunable masses 134 can be part of a keel system 140. In contrast to keels on sailing boats where the mass is shifted outboard in the port and starboard direction that is along the beam, the tuning masses 134 extend in the direction of the wave that is the length of the floating platform.

Still referring to FIG. 10, in addition to the tunable masses 134, the system 20 is tunable in that the track 24 has a variable radius. The radius of the track can be adjusted to tune the track, and, therefore, the system 20 to the waves 46.

The system 20 has a controller 142, in one embodiment that monitors various parameters including wave height and frequency. The controller has a computer or microprocessor and various input devices such as accelerometers, power meters, and global coordinate monitors. The controller 142 then is able to adjust items in the system 20 such as the location of the tunable masses 134 or the radius of the track 24 to adjust the system 20.

Referring to FIG. 11A, the floating platform 128 of FIG. 10 is shown on a wave 46 such that the leading edge 34 is near the crest 44 of the wave 46. Dependent on the size of the waves as defined as the height between the crest 44 and the trough 48, that the floating platform 128 is going to be used, the radius of the track 24 can be adjusted. A different radius of the track is shown in FIG. 12

FIG. 11B shows the floating platform 128 on a wave 46 such that the trailing edge 36 is near the crest 44 of the wave 46 and the leading edge 34 is near the trough 48. The constant changing of the relative heights of the track 24 near the leading edge 34 and the trailing edge 36 of the floating platform 128 by the hydraulic force of the wave is the source of energy used to allow the mass 26, the rolling energy generating mass, to roll along the track 24 and generate power.

The mechanism or system 20 is designed so that the natural frequency of each primary component of the dynamic system, the mass 26/track 24 and the hull 28 geometry can be optimally tuned, like a musical instrument, to work with the natural frequency of ocean waves 46 to maximize the creation of energy, power. Referring to FIG. 12, the floating platform 128 of FIG. 10 is shown with various elements tuned for a

wave 46. The radius of the track 24 has been adjusted therein varying the natural frequency of the mass 26/track 24. The radius of the track 24 can be changed by adjusting the track 24 or moving the radius of the curved portion 144 by lengthening or shortening a linear portion 146. In addition, the tunable masses 134 have been moved inward and the location of the mooring line 132 that is secured to the hull 28 has been moved to adjust the natural frequency of the hull 28.

A series of tests have been done using computer modeling. The model was done based previous modeling done in water tank and other real test data. The following are examples from the tests where the values have been scaled to real world numbers.

The hull 28 is designed for maximum stability and incorporates a “preload” feature. The mass 26, the rolling energy geometry mass, weighs 1,000,000 pounds in these tests. The hull 28 has to be stable enough to support the mass 26 at the fore and aft positions of the hull 28, and the leading and trailing edges 34 and 36. Stability is created by designing a hull 28 with enough draft to displace a volume of water that weighs equal to or is much larger than the weight of the mass 26 plus the total weight of the hull 28. As the ratio of volume of water displaced by the hull 28 to the weight of the mass 26 increases, the stability of the hull 28, metacentric height (GM), increases. Example: if the mass 26 weighs 1,000,000 pounds and a hull 28 is designed with enough draft to displace 2,000,000 pounds of water, the tunable masses 134 combined for a weigh of 2,000,000 pounds and will “Preload” the system with 2,000,000 pounds of force. The natural frequency of the hull 28 geometry can be tuned by adjusting, vertically and horizontally, the position of the tunable masses 134 in relation to the bottom of the hull or to the waterline.

The hull 28 is designed with a reserve buoyancy feature or freeboard. As the hull pitches fore and aft, the reserve buoyancy is used do add additional buoyancy to the hull, adding to the “Preload” force.

The natural frequency of the mass 26 can be tuned by adjusting the radius of the mass 26 track, the diameter of mass 26, and the length of mass 26.

The hull geometry is designed for a low moment of inertia. This means that the length of the hull should be much shorter than the beam of the hull. Think of a figure skater spinning with arms extended. As the figure skater’s arms move inward the skater’s moment of inertia decreases and the skater spins faster for any given amount of energy. As the hull’s moment of inertia decreases, more of the stored “Preload” energy is available to the system and more power can be generated.

It is recognized that the ocean, the water 18, cannot be tuned. Therefore, the properties of the waves 46 are monitored including the period of the wave and the wave height. The height of the water is also monitored. While several items can be tuned as discussed above, in one embodiment of a scaled model, the properties in the Table 1 were run.

Type of property	Property	Value
Hull Geometry	Length (ft)	40.0
Hull Geometry	Beam (ft)	100.0
Hull Geometry	Depth (ft)	27.52
Hull Geometry	Draft (ft)	13.76
Hull Geometry	Pitch Natural Frequency (Hz)	1.664
M1 & Track Configuration	Mass (M1) Diameter (Ft)	5.0
M1 & Track Configuration	Friction Coefficient	0.15

-continued

Type of property	Property	Value
M1 & Track Configuration	Track Radius (Ft)	21.25
M1 & Track Configuration	Natural Frequency (Hz)	1.310
M2 Configuration	Vertical Location from Bottom of Hull (Ft)	-40.0
M2 Configuration	Separation of Halves (Ft)	0.0
Mooring Configuration	Line Length (ft)	72.07
Mooring Configuration	Mooring Line Stiffness (N/m)	6825000
Mooring Configuration	Location of Mooring on Hull	Midships

The rate of travel, speed, of the mass 26 can be tuned to work the natural frequency of the system by adjusting its Friction Coefficient. The Friction Coefficient equals the amount of energy being taken out of the system.

When the ocean/wave properties have a natural frequency of 1 Hz, the average power generated is 1119.98 kilowatts. However if the ocean/wave properties change such that the natural frequency is 0.8 hertz, the average power generated drops to 658.09 kilowatts. By tuning various elements related to the system 20 as shown in Table 2, the average power generated is raised from the 658.09 kilowatts.

TABLE 2

Type of property	Property	Value
Hull Geometry	Length (ft)	40.0
Hull Geometry	Beam (ft)	100.0
Hull Geometry	Depth (ft)	27.52
Hull Geometry	Draft (ft)	13.76
Hull Geometry	Pitch Natural Frequency (Hz)	1.571
M1 & Track Configuration	Mass (M1) Diameter (Ft)	5.0
M1 & Track Configuration	Friction Coefficient	0.15
M1 (Mass 26) & Track Configuration	Track Radius (Ft)	15.56
M1 (Mass 26) & Track Configuration	Natural Frequency (Hz)	1.571
M2 (Tunable Masses 134) Configuration	Vertical Location from Bottom of Hull (Ft)	-40.0
M2 (Tunable Masses 134) Configuration	Separation of Halves (Ft)	18.0
Mooring Configuration	Line Length (ft)	72.07
Mooring Configuration	Mooring Line Stiffness (N/m)	6825000
Mooring Configuration	Location of Mooring on Hull	Midships

While the hull 28 geometry has not changed, the tunable mass 134 change in location adjusts the natural frequency of the hull 28.

By tuning both the track and the hull to change their natural frequency from 1.664 hertz to 1.571 hertz, the system 20 is better tuned to the ocean. The system 20 is tuned by the track radius being changed. The track radius is changed by either flexing the track or by moving the two curved portions further apart or closer together; FIG. 12 shows the curved portions separated by a linear portion. In changing the track radius, the natural frequency of the mass and the track changes. In addi-

tion, by moving the tunable masses **134** locations, the hull's natural frequency is changed without changing the size of the hull.

While not changed from the first run to second run shown above, the mooring system **131** can be used to tune the natural frequency of the mass **26**/track **24**/hull **28** geometry by adjusting the position that the mooring line **132** is attached to the hull **28**, by adjusting the length of the mooring line **132**, and by adjusting the properties and material from which the mooring line **132** is made. The mooring system **131** creates a reciprocating motion of the hull **28** in relationship to the anchor location, which can be used to tune the natural frequency of the system **20** for the purpose of maximizing energy output of the system **20**.

In addition to changing the property of the hull and the track, the rolling properties of the mass can be tuned further by having a locking mechanism related to the movement of the mass **26**.

TABLE 3

Locking Parameters	
Property	Value
Lock Angle	5
Lock Force	5
RV Limit (m/sec)	0.2
Pitch Rate Limit	0.5

The mass **26** can incorporate a "Brake/Lock" feature that can be used to stop the mass **26** or hold the mass **26** stationary at a fixed position once the mass **26** has stopped.

Type of property	Property	Value - Run 3	Value - Run 60
Hull Geometry	Length (ft)	40.0	40.0
Hull Geometry	Beam (ft)	100.0	100.0
Hull Geometry	Depth (ft)	27.52	27.52
Hull Geometry	Draft (ft)	13.76	13.76
Hull Geometry	Pitch Natural Frequency (Hz)	1.664	1.571
M1 & Track Configuration	Mass (M1) Diameter (Ft)	5.0	5.0
M1 & Track Configuration	Friction Coefficient	0.05	0.15
M1 & Track Configuration	Track Radius (Ft)	42.5	15.56
M1 & Track Configuration	Natural Frequency (Hz)	.897	1.571
M2 Configuration	Vertical Location from Bottom of Hull (Ft)	-40.0	-40.0
M2 Configuration	Separation of Halves (Ft)	0.0	18.0
Mooring Configuration	Line Length (ft)	72.07	72.07
Mooring Configuration	Mooring Line Stiffness	3140800	6825000
Mooring Configuration	Location of Mooring on Hull	Stern	Midships
Locking Parameters	Locking Angle	0	14
Locking Parameters	Locking Force	0	5
Locking Parameters	RV Limit	0	0
Locking Parameters	Pitch Rate Limit	0	0
Performance Summary	Avg. Power Generated (KW)	199.94	1302.01

Table 4 shows two different runs. The varying of the tunable parameters listed in Table 4 shows that the average power generated can be increased by factors such as 5 for the same wave state.

It is important that the energy developed by the rolling mass **26** be converted to electrical power without mechanical losses, maximizing the energy output of the system. Because the mass **26**, the rolling energy generating mass is rolling, there is a rotary motion that should be harnessed to the rotary motion of a generator. In a rotary to rotary system there are minimal energy losses due to gearing. In a rotary to linear system, such as a ball screw where linear motion is being converted to rotary motion (like wind being converted to the rotary motion of a propeller) the energy losses are substantial, 40% to 60% losses.

Referring to FIG. **13**, a graph shows the natural frequency of one run where the rolling mass **26** and the track **24** has a natural frequency of 1.57 hertz. The hull **28** geometry likewise has a natural frequency of 1.57 hertz. As indicated above, the hull **28** frequency is affected by several factors including the mooring system including the mooring line **132** and the position it is secured to the hull **28**. In addition the tunable masses' **134** location affects the natural frequency of the hull **128**. For an ocean having waves that have a natural frequency of 0.8 hertz, average power generated is: 1,302 KW (1.3 MW). In this run, the mass **26** had the locking mechanism described above actuated.

This mechanism or system **20** has two-degrees of freedom of motion. The hull **28** actuates independently and its pitch motion creates one-degree of freedom of motion, and the mass **26**, the rolling energy generating mass, which rolls on the track **24** attached to the hull **28** of the floating platform **22** or **128**, actuates independently in the same axis as the pitch of the hull **28** creating a dynamic second degree of freedom of motion. Unlike a traditional one-degree of freedom motor/generator, such as a conventional piston/cylinder in which power is generated and removed from the motor via the piston, in a two-degree of freedom motor/generator power is generated and removed from the motor via the dynamic second degree of freedom element, the rolling mass, M1 (Power=M1 divided by 550 ft/pounds per second).

The shape of the ocean wave, the wave's period and height, are what actuate the dynamic, two-degree of freedom, Mechanism/System. The Natural Frequency of the wave is tuned by the forces of nature. The ocean depth affects the shape of the wave, how steep it is. As waves approach the shore, they become steeper, which changes the natural frequency of the wave. A high frequency, short-wave-length wave has appreciable power even though its amplitude or wave height is relatively small. The rate of energy is proportional to the wave's speed. The natural frequency of the mass **26**/track **24**/hull **28** including the mooring system **132** of the system **20** can be tuned to work with the natural frequency of the wave in deep or shallow water.

While other ratios may work, it has been found that matching the mass **26**/track **24** and the hull frequency **28** to each other and having those frequencies be in the range of approximately 1.6 to 2 greater than the natural frequency of the ocean results in maximum power generated.

Referring to FIG. **14**, a perspective view of the unit **80** with the mass **26** in the form of the mass **80** and the mass **82** is shown on the track **24**. The track **24** has a pair of curved portions **144** and interposed linear portion **146**. The unit **80** has the electrical generator **96**.

It has been recognized that the hull **28** should be lightweight, and the mass **26** (M1) the rolling mass, should be heavy. The mass **26** is the mass that creates high power density energy. The hull **28** is basically a support platform for the mass **26**/track **24** and a mechanism to create displacement, buoyancy force. The tunable mass **134** (M2), the "preload"

11

weight, creates stability for the hull **28** by pulling the draft of the hull **28** down into the water, creating displacement, which produces a buoyancy force.

While various parameters have been tuned in the runs described, it is recognized that other items listed in the tables can be tuned. In addition, the mass or weight of the tunable masses **134**, the hull **28** and the mass **26** could be varied. The varying of each could be varied by switching out components or by adding or removing ballast. The geometry of the hull **28** could also be varied. The length of the hull influences the moment of the inertia. As further indicated below, the mooring arrangement can be tuned. The diameter and the length of the mass **6** also could be varied to tune the system **20**.

While the principles of the invention have been described herein, it is to be understood by those skilled in the art that this description is made only by way of example and not as a limitation as to the scope of the invention. Other embodiments are contemplated within the scope of the present invention in addition to the exemplary embodiments shown and described herein. Modifications and substitutions by one of ordinary skill in the art are considered to be within the scope of the present invention.

It is recognized that additional parameters can be tuned. For example, the mooring line **132** while moved from the trailing edge **36** in FIG. **10** to the midships in FIG. **12**, the length or material of the mooring line **132** did not change in the first two runs described. The length or material of the mooring line **132** could influence the natural frequency of the floating platform **22** or **128** of the system **20**. The anchor or where the mooring line is connected relative to the waterline also could be used in tuning the system **20**. The mooring system creates a reciprocating motion of the hull in relation to the fixed anchor location. As the fulcrum of the wave passes beneath the hull, the radius of the mooring line moves in an arc, creating a reciprocating motion. This is a tunable parameter. In addition, the track **24** could be further tailored to adjust the rate of roll.

It is further recognized that a flywheel can be used to capture and store energy from the rolling mass **26** and to drive a generating system. Because the rolling mass **26** changes direction of rotation on each side of the wave, a simple cam system can be used to keep the flywheel and/or generator always rotating in the same direction. Basically, a cam would flip when the rolling mass **26** reverses direction at the end of each stroke on the track **24**, causing the flywheel or generator to continue to rotate in the same direction even though the rolling mass **24** is changing direction.

In addition to electrical energy generated by the system **20** being transferred to shore via an underwater cable, electrical energy created by the system **20** can be used to manufacture a fuel such as hydrogen, which can be liquefied and transferred to shore via an underwater pipeline or a cargo ship. Submarines have been using this technology for a very long time. Electricity is used to separate hydrogen and oxygen from seawater. In a submarine, oxygen is used so that crewmembers can breathe, and the hydrogen is pumped back into the sea.

Each ocean energy system **20** is a modular vessel or floating platform. Each vessel will be registered as a ship. Each modular vessel can be attached to an array of other modular vessels to create an energy farm, so to speak, of modular vessels. An array of modular vessels would have an independent energy platform housing an electrical power station and/or a system to produce a fuel such as hydrogen.

It is recognized that electricity generated by the system can be used to convert seawater into hydrogen gas. This can be done onboard or on a nearby floating platform. The electricity

12

generated by the system can be used to produce any fuel. The electricity can be used to generate the desalinate seawater.

The invention claimed is:

1. A system for generating electricity from the hydraulic forces of waves, the system comprising:
  - a floating platform with a leading edge and a trailing edge floating on a body of water on which water in waves exerts hydraulic forces on floating objects;
  - a track mounted on the floating platform;
  - a mass carried on the track for moving relative to the track creating kinetic energy as the result of varying the orientation of the track by the hydraulic forces acting on the platform,
  - a mechanism to convert the kinetic energy of the mass moving along the track into electrical energy; and
  - a mechanism for tuning the mass relative to the floating platform to increase energy generated.
2. A system of claim **1** wherein the mechanism for tuning the mass relative to the floating platform includes adjusting the track therein varying the path of the mass.
3. A system of claim **2** wherein the mechanism for tuning includes a pair of curved track portions and a flat portion, the pair of curved track portions adjusted to vary the length of the flat portion of the track.
4. A system of claim **1** further comprising a mechanism for tuning the floating platform relative to the wave frequency to increase energy generated.
5. A system of claim **1** wherein the mechanism to convert the kinetic energy to electrical energy is a power unit having a frame and a pair of cylindrical masses, the masses coupled to an electrical generator for producing electrical energy.
6. A system of claim **5** wherein the energy is stored in batteries on the floating platform.
7. A system of claim **5** wherein the energy is transported by cable to another location.
8. A system of claim **1** wherein the floating platform has a beam and a length and the beam is greater than twice the length of the floating platform.
9. A system of claim **1** further comprising a weighted keel, the weighted keel has a pair of tunable masses that move along the center line.
10. A system of claim **1** wherein the means to convert the mechanical energy of the mass moving down the reverse incline planes into electrical energy further comprises a belt drive and a generator.
11. A system of claim **1** wherein the frequency of the mass and the track and the hull are generally tuned to the same natural frequency and that frequency is generally 1.6 to 2 times greater than the natural frequency of the waves.
12. A method for generating electricity from the hydraulic forces of waves on a body of water, the system comprising:
  - providing a floating platform having a track for carrying a mass;
  - floating the floating platform with a leading edge and a trailing edge on a body of water;
  - utilizing a wave on the body of water to raise the leading edge of the platform over the trailing edge, thereby the track forming an incline plane;
  - allowing the mass to move down the track thereby gaining kinetic energy;
  - using the kinetic energy of the mass moving down the track to turn a generator to produce electricity;
  - tuning the mass and the track relative to the waves to increase the energy generated; and
  - a mechanism for tuning the mass and the track relative to the floating platform to increase energy generated.

**13**

**13.** A method of claim **12** wherein the floating platform is tuned relative to the mass and the track and the waves to increase the energy generated.

**14.** A method of claim **13** wherein the floating platform is tuned by moving the location of a mooring line on the hull.

**15.** A method of claim **13** wherein the floating platform is tuned by providing a tunable mass in the water, wherein the tunable mass is secured to the floating platform and is movable relative to the floating platform to tune the natural frequency of the floating platform.

**16.** A method of claim **12** further comprises a braking mechanism for retaining the mass.

**14**

**17.** A method of claim **12** further comprising a controller to monitor and adjust the natural frequency of the hull and the natural frequency of the mass/track based on the natural frequency of the waves.

**18.** A method of claim **12** wherein the frequency of the mass and the track and the hull are generally tuned to the same natural frequency and that frequency is generally 1.6 to 2 times greater than the natural frequency of the waves.

**19.** A method of claim **12** wherein the tuning of the mass/track is done by adjusting the length of a linear portion of the track between two curved portions.

\* \* \* \* \*